

ITECC - General information

International Technology, Education and Commerce Campus

UTB/TSC acquired Amigoland Mall, a former retail venue located about one mile west of the Campus. UTB/TSC has been developing an innovative and creative program with emphasis on technical training, commerce and education targeted to the regional population. The site includes 540,000 square feet of building centered on the site. The building is surrounded by parking lots, with a capacity of approximately 3000 parking spaces. Additional smaller buildings are located in the parking lot facing Mexico Boulevard.

The objective of this study is to transform this retail mall into an educational campus.

Stated goals for ITECC include to develop new and enhanced existing programs designed to serve the technical workforce, training and education needs of the institution's international service region and to serve as a community partner in regional economic development.

Through ITECC, the school provides recognized programs that capitalize on the bi-lingual and bi-cultural advantages of the region, on-going program development and training curriculum that is relevant and current, and develops barrier-free pathways from Workforce Training and Continuing Education and technical programs to academic programs.

In addition, ITECC offers classroom and office space for traditional academic programs.

Legend

- Existing Buildings
- New Construction

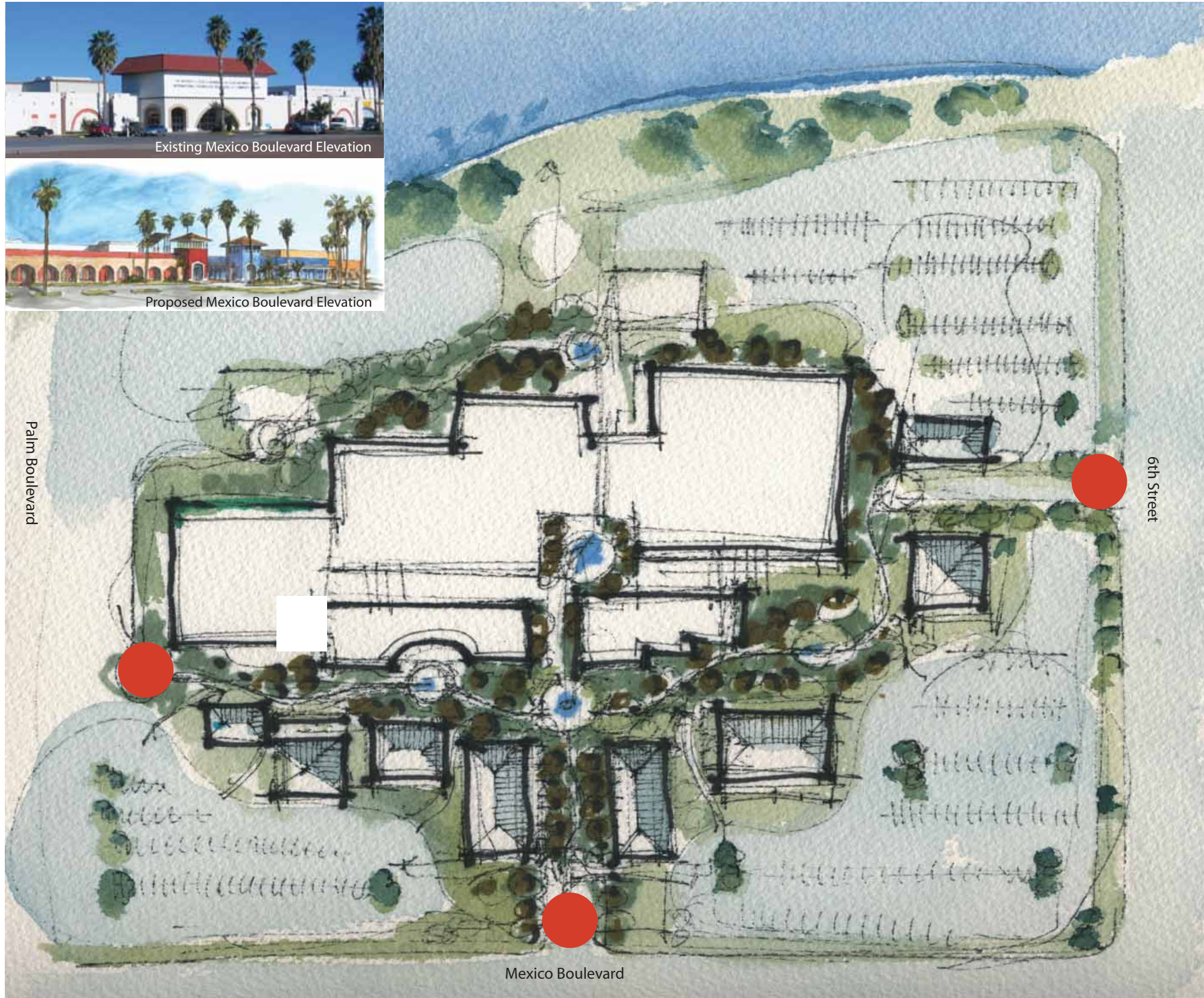

ITECC General Information (cont.)

The ITECC infrastructure and surroundings will be developed with an adaptable infrastructure which can accommodate ever changing technologies. Additional characteristics should include:

A physical signature which identifies it instantly with UTB/TSC.

A self-contained academic and training community which will be a model and catalyst for re-development of surrounding neighborhoods as well as downtown revitalization.

Include academic lower, upper, and graduate division classes as well as house faculty in order to expand learning opportunities.

Access and entryways -

The ITECC occupies a large site with access from three roads. The 6th Street access depends on its proposed extension.

The traditional principal entrance to the property is from Mexico Boulevard. This entrance provides opportunity to introduce the new identity for the ITECC through a revised architectural character to the campus. This entrance will become a promenade with a divided four lane approach. Palm trees will flank the promenade. The drive, paved to provide texture and color, terminates in a landscaped round-about. Depending on future facility needs, the master plan lays out the development of future buildings at either side of the promenade to help the pedestrian scale and enhance the approach to the campus.



● Location of major vehicle gates to the ITECC Campus